



# INSTALLATION INSTRUCTIONS

**1051WM-SB | RGBW**

COMMERCIAL SERIES LINEAR FLOODLIGHT WITH SURFACE BOX

**IMPORTANT NOTE:** Aluminum Surface Box must be installed and grounded in accordance with the National Electrical Code (NEC) and local codes. All conduit entries must be sealed from moisture. Use appropriate sealing material on conduit fittings and conduit closure plugs. Luminaire fitting is wet location listed and suitable for wall and ceiling mounted applications. Luminaire fitting is suitable for all types of construction including semi-recessed in concrete construction and surface mounting onto various wall and ceiling surfaces.



## SURFACE / WALL / CEILING INSTALLATION

**IMPORTANT NOTE:** Temporary Cover Plate and Vinyl Label **must** remain in place during Surface Box Housing installation.

1. Position Surface Box Housing onto desired location on wall or ceiling. If mounted over 4-0 recessed electrical box, or over stub out conduit, align Surface Box Housing such that internal knockout features align with electrical service. Knock out mounting holes within the Surface Box Housing, and affix the Surface Box Housing to the wall using appropriate hardware. (hardware by others). Tighten hardware such that the sealing gasket mounted on back of the Surface Box Housing is fully compressed between the wall and the back of the Surface Box Housing.
2. The Surface Box Housing is equipped with two separate splicing Junction Boxes (one for Power, one for DMX communication). If surface conduit is used, connect separate conduit runs to each of the two Junction Boxes in the Surface Box Housing.
3. Plug any unused NPT holes with closure plugs (provided).
4. To pull Power conductor and DMX communication wiring, first remove and retain the Temporary Cover Plate and Vinyl Label by using an Allen wrench (provided).
5. Pull electrical Power wires (line in) through conduit and into one of Junction Boxes. For through branch wiring, pull wires upward making a 6" loop above the top rim of the junction box. Designate this Junction Box for Power.
6. For DMX wiring, pull a suitable DMX cable in a similar manner to the Power supply conductors into the second Junction Box designated for DMX communication. It is recommended that the DMX cable be suitable for EIA-485 (RS-485) use, with one or more low capacitance twisted pairs, with overall braid and foil shielding. Conductors should be 24 AWG (7/0.2) or larger for mechanical strength and to minimize volt drop on long lines. Designate this junction box for DMX communication.
7. Stuff the wire loops back into the Junction Boxes, and reinstall the Temporary Cover Plate with Vinyl Label onto the Surface Box Housing with screws provided.

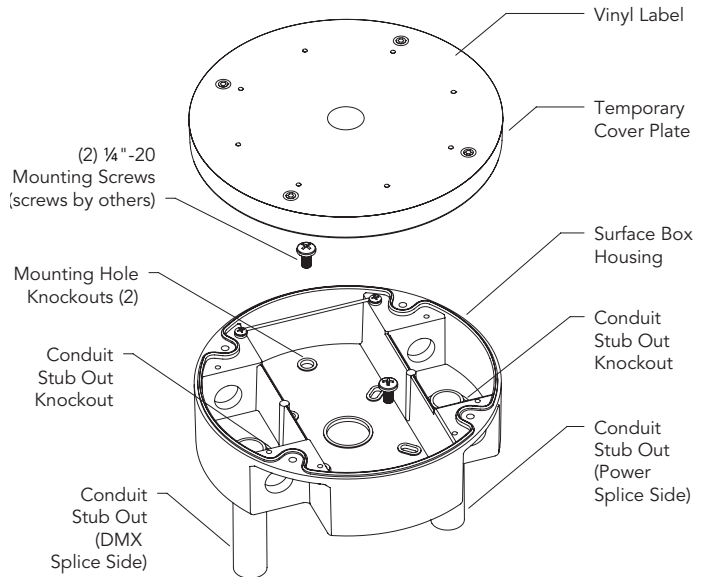

STUB OUT / 4-0 BOX ELECTRICAL INSTALLATION

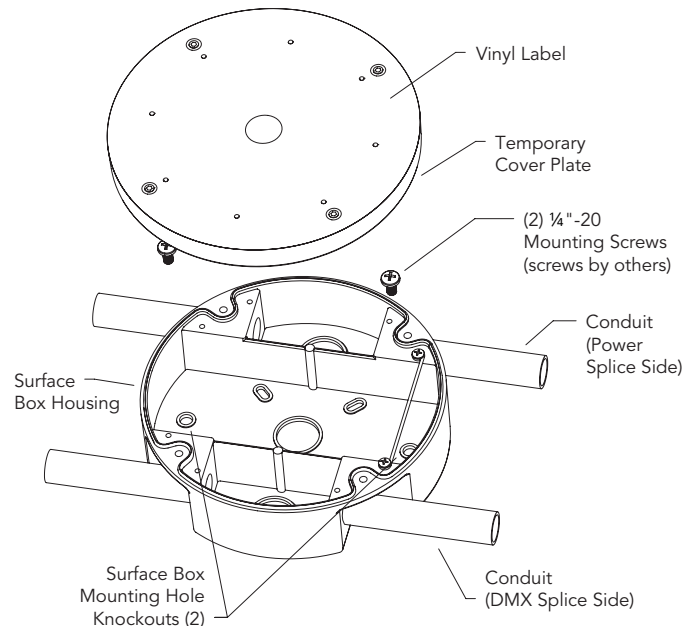

SURFACE CONDUIT INSTALLATION



**PROFESSIONAL  
OUTDOOR LIGHTING**

**www.VistaPro.com · email@vistapro.com · Fax: (888) 670-VISTA (8478)**

1625 Surveyor Avenue · Simi Valley, CA 93063 · (805) 527-0987 · (800) 766-VISTA (8478)

Vista Professional Outdoor Lighting reserves the right to modify the design and/or construction of fixtures shown in this document without further notification.

Page 1 of 3  
REV 09.25.24



### SURFACE / WALL / CEILING – RECESSED CONCRETE INSTALLATION

**IMPORTANT NOTE:** Temporary Cover Plate and Vinyl Label **must** remain in place during Surface Box Housing installation.

1. Position the Surface Box Housing onto the concrete wall form such that Temporary Cover Plate is FLUSH to finish grade. Use threaded rod & wing nut kit (provided) to secure Surface Box Housing to pour form. Pierce through the Vinyl Label with the threaded rod when installing Surface Box Housing onto forms.
2. The Surface Box Housing is equipped with two separate splicing Junction Boxes (one for Power, one for DMX communication). Connect separate conduit runs to each of the two Junction Boxes in Surface Box Housing. Use UL listed outdoor rated conduit for in and out connections to ensure water tightness of splices.
3. Pour concrete into form completely covering the Surface Box Housing / conduit runs. Vibrate the concrete to eliminate any voids. Allow concrete to cure.
4. Remove forms from poured concrete. **IMPORTANT! – REMOVE THREADED RODS & WING NUTS PRIOR TO REMOVING FORMS. FAILURE TO DO SO WILL RESULT IN DAMAGE TO SURFACE BOX HOUSING AND WILL VOID WARRANTY**

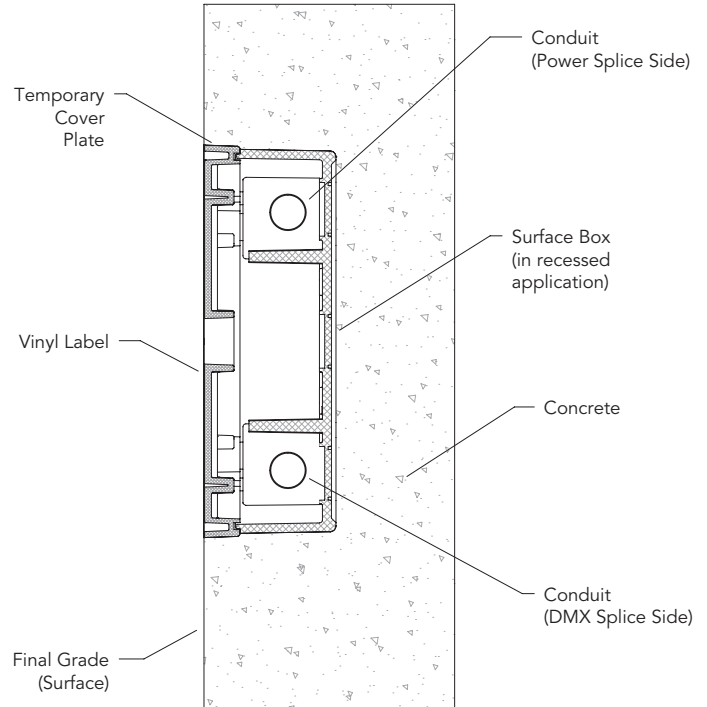

RECESSED CONCRETE INSTALLATION

### WIRING INSTALLATION

1. To pull Power conductor and DMX communication wiring, first remove and retain the Temporary Cover Plate & Vinyl Label using an Allen wrench (provided).
2. Pull electrical Power wires (line in) through conduit and into one of Junction Boxes. For through branch wiring, pull wires upward making a 6" loop above the top rim of the Junction Box. Designate this Junction Box for Power.
3. For DMX wiring, pull a suitable DMX cable in a similar manner to the Power supply conductors into the second Junction Box designated for DMX communication. It is recommended that the DMX cable should be suitable for EIA-485 (RS-485) use, with one or more low capacitance twisted pairs, with overall braid and foil shielding. Conductors should be 24 AWG (7/0.2) or larger for mechanical strength and to minimize volt drop on long lines.
4. Stuff the wire loops back into the Junction Box and reinstall the Temporary Cover Plate with screws supplied.





### RGBW LED FIXTURE WIRING AND SURFACE BOX COVER INSTALLATION

1. Remove Temporary Cover Plate with Vinyl Label. Recycle or discard cover plate.
2. The RGBW LED Fixture / Surface Box Cover assembly is pre-wired from the fixture to the driver, with the Surface Box Cover assembly having two output wiring sets, one designated for Power, and a second for DMX communication. Each of these wiring sets is to be terminated into separate Junction Boxes within the Surface Box Housing that have been designated for Power and DMX communication.
3. Position the fixture / Surface Box Cover assembly over the Surface Box Housing such the Power wiring and DMX communication wiring are aligned with the separated Junction Boxes designated for Power and DMX communication.
4. In the Power splice Junction Box, pull the Power conductor wire loops out of the Junction Box, cut at center and strip the leads.
5. Using the silicone filled wire nuts (provided), connect the Power conductors in the Power Junction Box to the Power wiring set of the RGBW LED fixture / Surface Box Cover noting the following polarity:  
Supply (+) to Load (Black)  
Supply (-) to Load (White)  
Supply (Ground) to Load (Green)
6. In the DMX communication Junction Box, use the Wago® lever splices supplied to attach the incoming and outgoing DMX positive (+), DMX negative (-), and drain of the Surface Box Cover to the supply DMX communication cable. Please note the markings that identify the incoming DMX (+), DMX (-), and outgoing DMX (+) and DMX (-).
7. Terminate the DMX (+) and DMX (-) end cabling of the Surface Box Cover with 120Ω resistor.
8. Position the lid on the RGBW Surface Box and affix the lid onto the RGBW Surface Box.
9. Tighten four screws fully.
10. Aim and adjust fixture to target.
11. Supply power and DMX signal to the luminaire and check for proper operation.

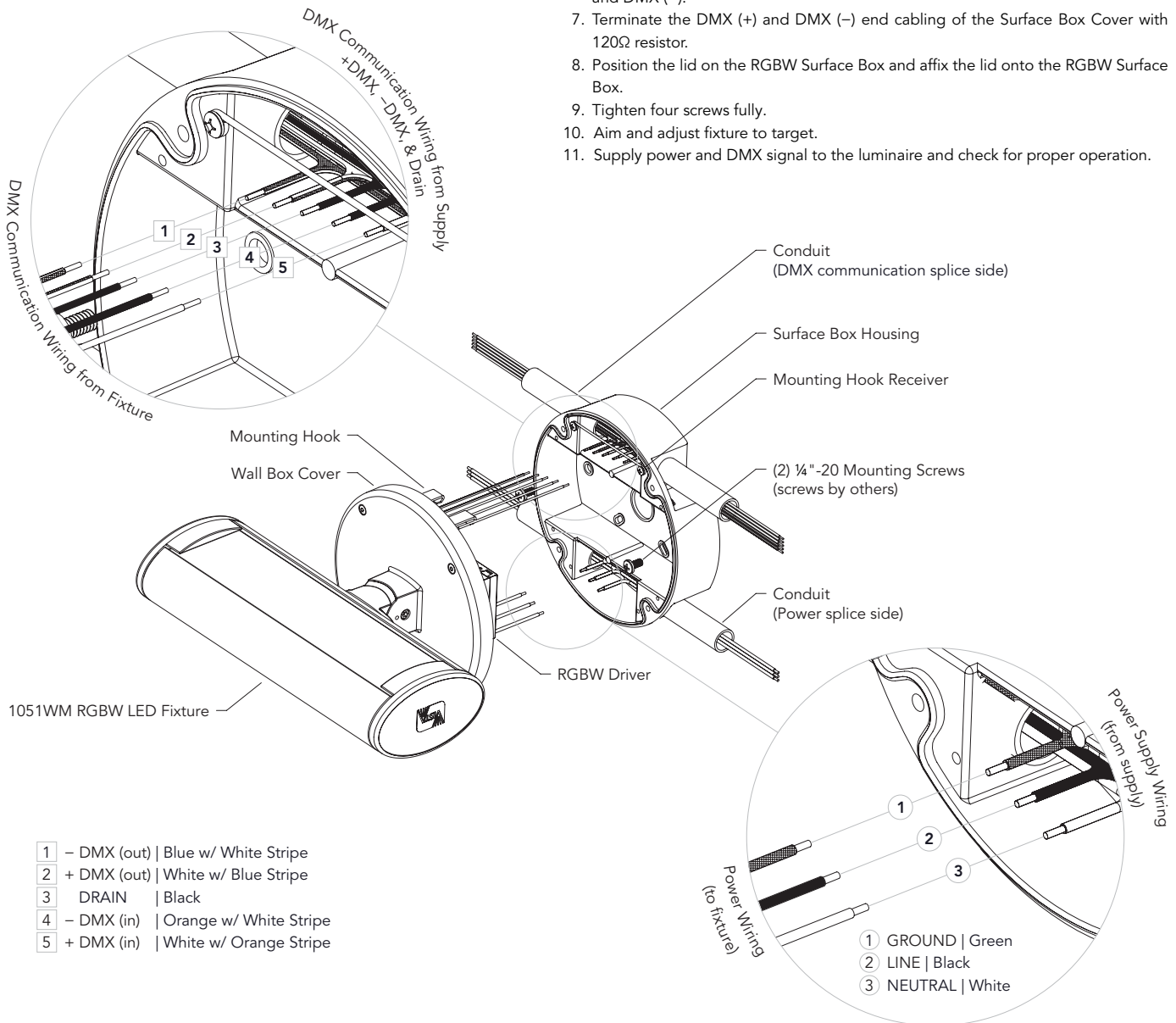

At Vista's exclusive discretion, replacement or repair of authorized return items, found to be defective upon inspection within the warranty period, shall constitute fulfillment of all Vista obligations under its warranties.

