



1054WM • RGBW • WALL MOUNT

Specification Sheet | Commercial Series • Linear Floodlight

TYPE:

MODEL:

PROJECT:

PRODUCT FEATURES



Wattage	100 W (MAX)
Voltage	120 – 277 VAC
Lumens	8346 Delivered Lumens (MAX)
Distribution	Narrow, Medium Flood, Wide Flood, Wall Wash, Wall Grazer, Asymmetric
Color	RGB and Tunable White (2200K – 6000K)
Controls	DMX 512-A with RDM capabilities
Driver	4 channel DMX512-A/RDM compatible
Fixture Dimensions	48" W x 6 3/4" H
Wall Box Dimensions	8" DIA x 2 3/4" D



ORDERING INFORMATION

EXAMPLE: 1054WM-GM-MF-RGBW-SB12-MV-DMX-GS

MODEL	FINISH	DISTRIBUTION	COLOR	MOUNTING	VOLTAGE	CONTROL	ACCESSORIES
1054WM			RGBW		MV	DMX	

MODEL	FINISH				DISTRIBUTION		COLOR		
1054WM	B	Black	BR	Architectural Brick	G	Verde	NS	Narrow	RGBW RGB + Tunable White
	Z	Architectural Bronze	LZ	Light Bronze	P	Pewter	MF	Medium Flood	
	DZ	Dark Bronze	SB	Special Bronze	M	Mocha	WF	Wide Flood	
	GT	Granite	GG	Glossy Gray	OF	Olde Finish	WW	Wall Wash	
	W	White	R	Rust			WG	Wall Grazer	
			HG	Hunter Green			AS	Asymmetric	
			WB	Weathered Bronze					
			WI	Weathered Iron					
			GM	Graphite Metallic					
MOUNTING		VOLTAGE		CONTROL		ACCESSORIES			
SB12 Surface Box ½” NPT hubs		MV Multi Volt (120-277VAC)		DMX DMX 512-A with RDM capabilities		GS Internal Glare Shield			
SB34 Surface Box ¾” NPT hubs						VR Polycarbonate Lens			
SBKO Surface Box 4-0 Box Knockout									



PROFESSIONAL
OUTDOOR LIGHTING

www.VistaPro.com • email@vistapro.com • Fax: (888) 670-VISTA (8478)

1625 Surveyor Avenue • Simi Valley, CA 93063 • (805) 527-0987 • (800) 766-VISTA (8478)

Vista Professional Outdoor Lighting reserves the right to modify the design and/or construction of the fixture shown without further notification.



SPECIFICATIONS

FIXTURE HOUSING:

Extruded aluminum body with die-cast aluminum end caps and mountings. Optic and driver compartment environmentally sealed. Mounted on die cast aluminum fitting. Adjustable $\pm 15^\circ$.

WALL BOX HOUSING:

2 boxes included. Die-cast A360 aluminum. Separate power and communication splicing compartments environmentally sealed. Integral 4 channel DMX driver completely wired by factory.

FINISH:

Powder coat finish available in Black, Architectural Bronze, Dark Bronze, Granite, White, Architectural Brick, Light Bronze, Special Bronze, Glossy Gray, Rust, Hunter Green, Weathered Bronze, Weathered Iron, Graphite Metallic, Verde, Pewter, Mocha, and Olde Finish. Custom Powder coat finishes available on request.

REFLECTOR:

Specular or semi-specular extruded aluminum optics anodized and bright dipped for maximum reflectivity.

ACCESSORIES:

Internal Glare Shield **GS**, Polycarbonate Lens **VR**

WIRING:

- **Power:** 3 conductors. Terminates in isolated power junction box of the Surface Box.
- **Communication:** DMX, 2 twisted pairs in & out plus drain, terminates in isolated communication junction box of the Surface Box.

MOUNTING:

- **Fixture:** Die-cast, aluminum Wall Mount, affixed with stainless steel hardware and factory mounted to the Surface Box Cover. Wall Mount is adjustable for precise aiming.
- **Surface Box:** Two size $\frac{1}{4}$ -20 knockout holes provided for surface mounting with fasteners (by others).
- **Concrete Pour Mask (CPM):** Included for recessed mounting in concrete. Also included is an 8-32 rod kit for attachment of the Surface Box to pour forms.

CERTIFICATION:

UL wet location listed.

LED:

White and RGB LEDs arranged in four channel configuration. Configuration allows for infinite color combinations.

CONTROLS:

Integral drivers equipped, **Two (2) included in Surface Boxes**, with DMX512-A protocols.

Each integral driver has a unique 12 digit UID.

Fixture identification accessible through RDM and consumes **2 Nodes** on a standard **32 Node** (max) DMX BUS.

COLOR RENDERING (WHITE):

90 CRI minimum at 3000K

OPTICS/AIMING:

NEMA defined floodlight optics with wide lateral throws – extruded aluminum. $\pm 15^\circ$ aiming adjustment

LIGHT DISTRIBUTION [WHITE]:

Narrow **NS** (88.3° H x 28.4° V) | Max. Candela: 6121

Medium Flood **MF** (95.3° H x 57.3° V) | Max. Candela: 2521

Wide Flood **WF** (78.2° H x 88.2° V) | Max. Candela: 3102

Wall Wash **WW** (83.5° H x 50.5° V) | Max. Candela: 4176

Wall Grazer **WG** (101.1° H x 20.6° V) | Max. Candela: 11481

Asymmetric **AS** (91.8° H x 67.3° V) | Max. Candela: 4146

DRIVER:

4 channel DMX512-A/RDM compatible driver 12 digit UID number.

Driver is factory set to start Channel 1:

Channel 1 – Red

Channel 2 – Green

Channel 3 – Blue

Channel 4 – White

The start channel can be changed during commissioning via RDM using the driver 12 digit UID number.





DIMENSIONS

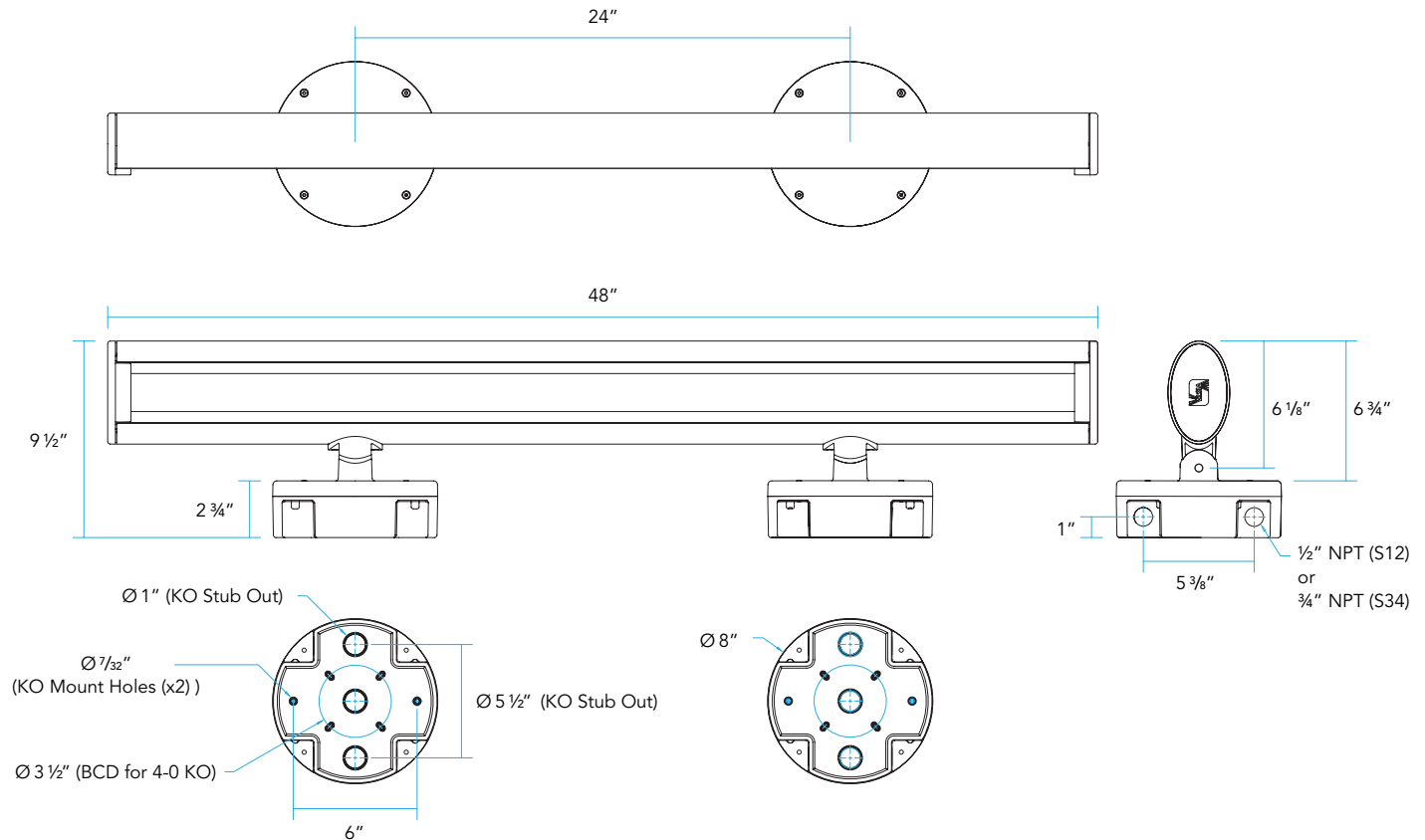

DELIVERED LUMENS SPECIFICATION

DISTRIBUTION	RED	GREEN	BLUE	WHITE
Narrow NS	30 Watts 791 Lumens	41 Watts 1884 Lumens	40 Watts 426 Lumens	96 Watts 6489 Lumens
Medium Flood MF	30 Watts 1009 Lumens	42 Watts 2473 Lumens	41 Watts 562 Lumens	98 Watts 8271 Lumens
Wide Flood WF	31 Watts 884 Lumens	42 Watts 2073 Lumens	42 Watts 553 Lumens	99 Watts 6630 Lumens
Wall Wash WW	31 Watts 916 Lumens	42 Watts 2131 Lumens	43 Watts 562 Lumens	99 Watts 6930 Lumens
Wall Grazer WG	31 Watts 1073 Lumens	42 Watts 2550 Lumens	42 Watts 680 Lumens	100 Watts 8346 Lumens
Asymmetric AS	29 Watts 908 Lumens	41 Watts 2157 Lumens	41 Watts 485 Lumens	96 Watts 7069 Lumens





CHROMATICITY

COLOR TEMPERATURE WHITE [W]:

2200K – 6000K CCT

RED WAVELENGTH [R]:

619nm – 625nm

GREEN WAVELENGTH [G]:

520nm – 530nm

BLUE WAVELENGTH [B]:

465nm – 475nm

LED MODELS:

Lumileds LUXEON 2835 HE

Lumileds LUXEON 3528 RGB

- R** Red Wavelength Range
- G** Green Wavelength Range
- B** Blue Wavelength Range
- W** White Color Temperature Range
- A** Combined RGB Visible Color Range

